

**STC 55**

**GREEN GLUE ASSEMBLY**

<b>Wall</b>	5/8" Drywall Green Glue (2 tubes per 4'x8' sheet) + 5/8" Drywall
<b>Framing</b>	2x4 Wood Stud (24" OC)
<b>Insulation</b>	R13 fiberglass insulation
<b>Wall</b>	5/8" drywall + Green Glue @ 2 tubes per 4'x8' sheet + 5/8" drywall
<b>Orfield Labs NVLAP certified</b>	<b>OL-05-1049</b>

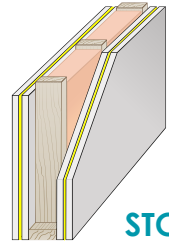

**STC 45**

**ENGINEERED DAMPING GLUE**

<b>Wall</b>	5/8" drywall + Engineered Damping Glue @ <b>2.5 tubes</b> per 4'x8' sheet + 5/8" drywall
<b>Framing</b>	2x4 Wood Stud (24" OC)
<b>Insulation</b>	R13 fiberglass insulation
<b>Wall</b>	5/8" drywall + Engineered Damping Glue @ <b>2.5 tubes</b> per 4'x8' sheet + 5/8" drywall
<b>Orfield Labs NVLAP certified</b>	<b>OL 06-0940</b>

Engineered damping glue was purchased by independent contractors through standard retail channels.

Independent contractor assembly was conducted under lab supervision at Orfield Laboratories.

Glue was applied according to the manufacturer's instructions.

The processed was filmed and a wall sample retained by the lab.

See certified test report for more details.

